

Università di Firenze - Dipartimento di Architettura
Corso di laurea magistrale in Architettura – curriculum Architectural Design
iCad - International Curriculum on Architectural Design - Master Program
Architecture and Town Lab
Module Urban Landscape Design

Urban Landscape Design

antonella valentini

contact:

antonella.valentini@unifi.it



goals

1 To **give a basic knowledge** of the discipline of landscape architecture based on theory and practices

- Lectures on theory

Starting from a short historical review, we discuss on the concept of Landscape, reflecting in particular on the changes in the contemporary approach design after the Landscape Convention (2000)

- Lectures on practice and technique

To give practical information on some themes (roof garden, vertical garden, community garden...) that could be also useful for the Lab Project

2 it aims to **develop skills to integrate landscape architecture to different disciplines** (urban and architectural design) as usually happens in professional practice, especially at urban scale

3 To **develop a master plan** at urban scale being able to integrate 3 disciplines (town planning, landscape architecture, architectural design)



Università di Firenze - Dipartimento di Architettura
Corso di laurea magistrale in Architettura – curriculum Architectural Design
iCad - International Curriculum on Architectural Design - Master Program
Architecture and Town Lab
Module Urban Landscape Design

topics

Landscape: concept and application

concept of Landscape in Italy and abroad, and its application (laws, practices....)

Brief history of Landscape Architecture

from ancient Egypt, Iraq, Greek and Roman gardens to 19th and 20th century.....

Reference Authors

Some protagonists of the 19th and 20th century as Pietro Porcinai, or F.L. Olmsted

Reference Projects

Some urban landscape project of the late 20th century and contemporary examples: from La Villette to High Line

Green system/Green infrastructure

Linear open space systems allow penetration into the urban fabric and contribute to the environmental readjustment of settlement.

Boundary Landscape

Instruments to plan peri-urban landscapes, for their readjustment and regeneration

Themes

Urban farming, community gardens, pocket gardens, urban greenways, gardens in motion, guerrilla gardening, vertical gardens, roof gardens...

Principles and elements for design

Design principles and elements: soft-scape and hard-scape, vegetation, paving, furniture



1 preliminary exercise

During the course, there is a mid-term examination. As the students attending the course are coming from different countries, the preliminary exercises are thought **to share this cultural heritage**

One or two A3 sheet, saved as image (jpg or pdf) with good resolution but NOT too heavy!

Every work is presented to the class, each student share to the others this information, helping to a deeper knowledge about the many different cultures.

This work is **individual**.

You must deliver it by e-mail within the day before the public presentation in classroom



Preliminary exercise

For me a good landscape project is...

Analytic schedule on a landscape project or a landscape architect

The exercise is a brief research on a **garden/park/square/system of urban space/plan.....**that the student considers representative of the idea of “*good project of landscape*” and also it could be representative of his/her own country, but students can choose freely the example, not strictly linked to their own countries. Could be also a research on a landscape architect. Projects must be **contemporary** or dated in the second part of the XX century



Università di Firenze - Dipartimento di Architettura
Corso di laurea magistrale in Architettura – curriculum Architectural Design
iCad - International Curriculum on Architectural Design - Master Program
Architecture and Town Lab
Module Urban Landscape Design

Lab. final project: a project in an urban area

To develop a complex neighborhood project (master plan) which works at different scales and mediates between different problems

a project for the rehabilitation of a public housing neighborhood in the periphery of the city of Prato. The topic will be developed in coordination with the municipality of Prato and with the managers of the public housing heritage of Prato.

students must develop a vision of **new structure and organization of open spaces** that combine existing open spaces with projected ones.

methodology: analysis, diagnosis, design

After have done some analysis to identify the key characteristics of the landscape (**open spaces survey**), students define the **strategy** and the main goals (landscape quality objectives) and draw the **master plan** of the area (scale 1:2000, 1:1000). Then, they go deeply to a part of the neighborhood and they develop it **through plans, sections, details, views** (scales to be defined).

Lab final project is a team work (max 3/4 students per group, different nationalities)



1

Analysis

Open Space Survey (analysis and diagnosis):

To identify the **key characteristics** of the landscape. All the open spaces (= **empty areas**) are represented

- **structure of the existing greenery**

representation of the existing vegetation: essential basis on which the project is founded (trees, lawns, hedges and shrubs only if they are very extended)

- **functions and roles of existing open spaces**

use of open spaces, both public and private

- **Connections**

system of circulation and accessibility es. footpaths, trails, points of aggregation ...

- **Values**

Historic-architectural values (monumental buildings, attraction points ...) and **natural values** (gardens and parks...)

- **visibility and perception**

footpaths, trails, points of aggregation, rows of trees, visual lines, emerging elements, detractors ...

2

Diagnosis

critical issues and potentialities

barrier, use interrupted, marginal places or without character, items to enhance and strengthen ...

3

Project (master plan)

Vision of new structure and organization of open spaces that combine existing open spaces with projected ones

Scale: 1:10.000/1:5.000/1:2.000/1:1.000

Examples of the preliminary assignment

MAURO STACCIOLI'S RING, Volterra, 1997

Student Sofia Lalli

Poggio San Martino, cement and iron, cm Ø600x50

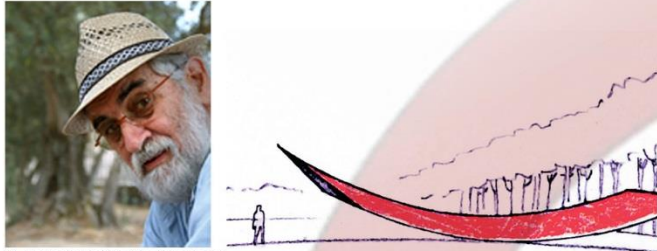

1,2. Mauro Staccioli: Sketch of size project

Mauro Staccioli - Considered one of the fathers of contemporary art, Mauro Staccioli, a native of Volterra, left his hometown many of the great environmental works installed in 2009 for the exhibition "Sites of Experience".

A path marked by geometric minimalist sculptures of gigantic dimensions through which the artist reinterprets the landscape of Volterra and relives his childhood memories. One way to discover the countryside of Volterra, through views and frames that change and renew themselves every day in an ongoing and changeable between work, landscape and viewer. Ideal for photo enthusiasts, art and nature.



3. Poggio San Martino, Ring, 1997, cement and iron, cm Ø600x50cm

Ring The ring from the typical red oxide dear to Staccioli gives the sweet hilly landscape of Volterra a new visibility and leads the eye to the metalliferous hills beyond the verdant slopes. This kind of frame-round screen forces to slow the race down the slope leading to Volterra and forces the passerby not to see but look, and then contemplate the scenario that unfolds within it.



4. Farm Lischetto. Portal 2009 Corten steel, cm 1000x805x55



5. The Boldria 2009, cement and iron, cm Ø600x60



6. Location La Mestola. Solid round 2009, cement and iron, cm Ø600x60

Sites of Experience - The ring is part of the exhibition project of Mauro Staccioli, "Volterra - Sites of Experience" which consists of the installation of twenty sculptures set in the landscape, as well as in places and historic squares. The repetition of some of the works displayed in Volterra in 1972, the artist goes on to develop a dialogue with the whole of the city, through the creation of new works that emphasize time and place of a landscape where history, culture and work human meet, stressing the very memory of the author, a native of this land. The exhibition is accompanied by a catalog the size of 25x30 cm, it consists of 176 pages, printed in four colors, bound hardcover.



7. Location Montebradoni. 2007-2009 Imperfect circle, red plaster, 350x350x45 cm

8. Farm Fognano. San Giacomo in Fognano 1985-2009, red cement and iron, cm 125x2100x100 cm

Feelings I chose this project because I love it and every time I step in Volterra I want to stop to take pictures. It is an amazing and simple way to enhance the landscape, creating a huge frame that bracket it. I like how the artist uses objects to frame the landscape, which therefore becomes the subject, he chooses places that represent him inviting the viewer to grasp certain glimpses through his sculptures. It is a work of sculpture, but I believe we can also consider it as a landscape project because is primarily intended for this.

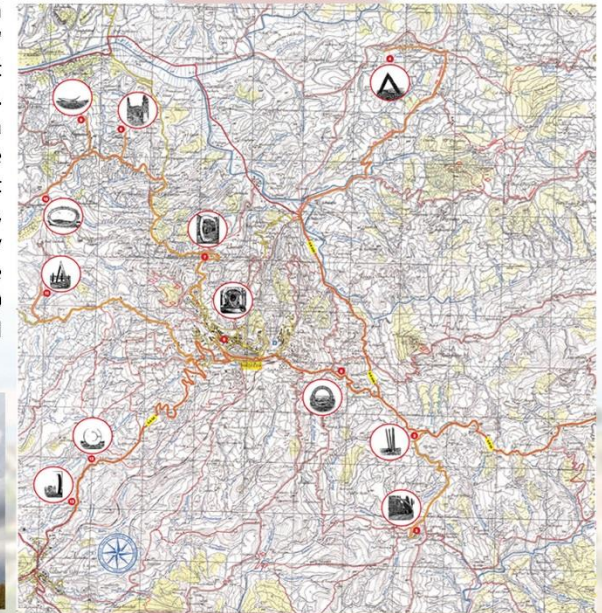

Map of the sites

1995-2007

"Il Vulcano Buono"

Nola, Italy

Located in the countryside outside Naples, this mixed-use centre is a modern version of a traditional marketplace, designed by architect Renzo Piano.

The centre includes a superstore, a shopping mall, entertainment and public spaces, restaurants, a hotel, offices and other facilities.

This is a building that **relates to the location and topography of the area**; with it organically integrates and expresses itself outwardly as a great lifting soil that resembles the shape of the volcano, Vesuvius, so outstanding the Naples area.

40 meters high and with a diameter of more than 170, the complex building is characterized by the fact of having fed great attention to the look and **eco-oriented design**. Around it were planted over 2,000 trees, a huge artificial lung that seems to incorporate naturally inside the shopping area. The roof of the building is covered by a layer that contains more than 2,500 plants, useful to isolate the interior spaces as well as to reduce the visual impact of the building for those who see it from above.

The second key element is the membership of the "**Central square**", which is inspired by the Piazza Plebiscito, a large open space of more than 160 meters in diameter protected from cold winds in winter by the shape of the building itself, and cooled in the summer presence of green spaces and trees placed radially to the center of the square. And 'in the heart of the building, in fact, in its crater, that the **void becomes the meeting place** between people.

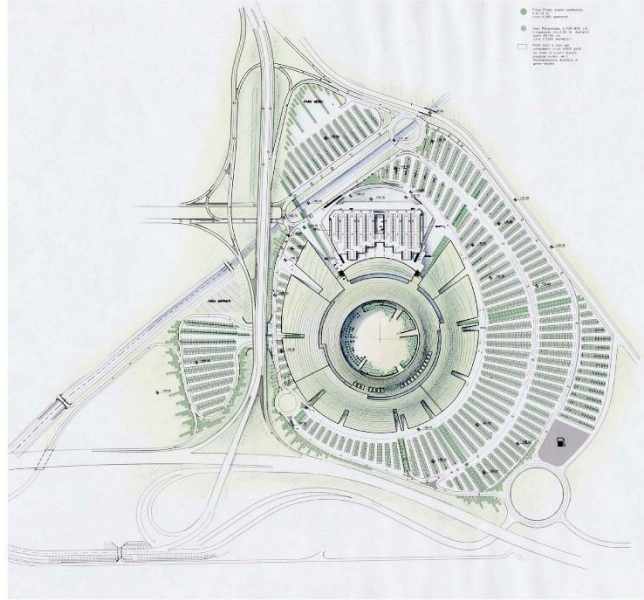
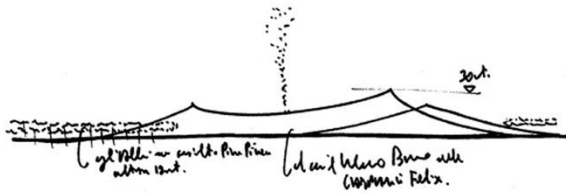

STUDENT Lucia Chirichello

Christo and Jeanne-Claude
The Floating Piers

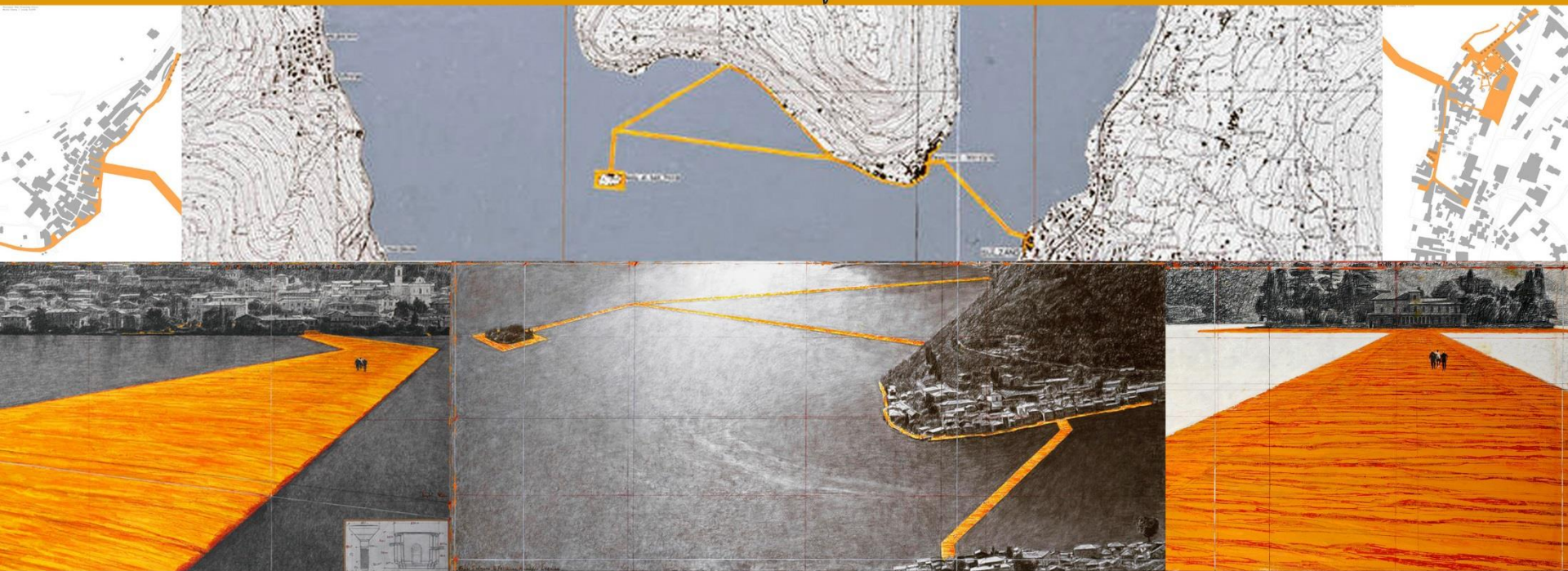

The Floating Piers is a site-specific work of art by Christo and Jeanne-Claude, consisting of 100,000 square meters of yellow fabric, carried by a modular floating dock system of 220,000 high-density polyethylene cubes installed at Lake Iseo near Brescia, Italy. The fabric created a walkable surface between Sulzano, to Monte Isola and to the island of San Paolo (that is a private isle owned by the family Beretta). The Floating Piers was first conceived by Christo and Jeanne-Claude together in 1970. It was Christo's first large-scale project since Christo and JeanneClaude realized The Gates in 2005, and since Jeanne-Claude passed away in 2009. As with all of Christo and JeanneClaude's projects, The Floating Piers was funded entirely through the sale of Christo's original works of art. After the 16-day exhibition (18th June, 3rd July), all components were removed and industrially recycle.

A 3-kilometer-long walkway was created as The Floating Piers extended across the water of Lake Iseo. The piers were 16 meters wide and approximately 35 centimeters high with sloping sides. The fabric continued along 2.5 kilometers of pedestrian streets in Sulzano and Peschiera Maraglio.

"Those who experienced The Floating Piers felt like they were walking on water - or perhaps the back of a whale," said Christo. "The light and water transformed the bright yellow fabric to shades of red and gold throughout the sixteen days."

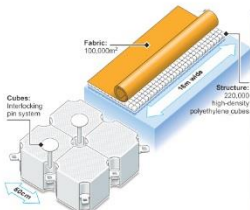

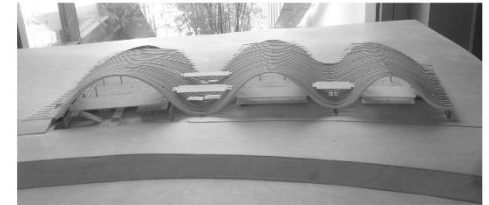
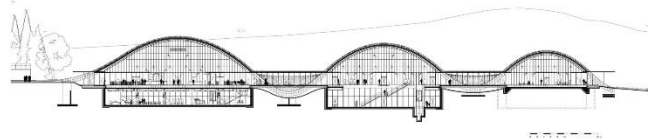
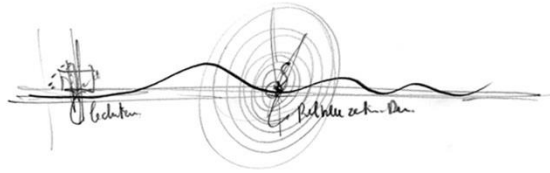

The complex nature of the shapes and articulations of the body of work of German-Swiss artist Paul Klee is reflected in the architecture of the Zentrum. The museum is part and parcel of the rolling hills and blends in with the natural landscape of the countryside outside of Bern. Its curved roof made of long steel beams welded together one by one, houses one of the most extensive monographic collections in the world.

The museum was commissioned by the artist's heirs and was the fruit of the generosity of arts patron Maurice E. Müller. Built to house over 4,000 of Paul Klee's works of art under a single roof, the Zentrum is located in the eastern outskirts of Bern, an area marked on one side by a motorway and on the other by the distant profile of the Alps. One of the inspirations for the project's design was the morphology of the region, its vast expanse of hills and cultivated fields.

The architecture of the Zentrum was conceived as a gentle wave contouring the land. It is barely visible from a distance, the curvature of the structure creating three artificial hills containing the exhibition space, a concert hall, a conference centre and a centre for the study, research and promotion of Klee's works, as well as an interactive museum for children known as Creaviva, which also organises workshops on topics revolving around art. If the artistic themes encompassed by the museum reflect the multidisciplinary talent of the German-Swiss Klee - an artist and teacher with close ties to music and poetry -, the design of the building and the physiognomy of its space interpret his passion for harmony of form and the proportions of nature.

The three rolling 'hills' are connected by a covered pathway that runs along the entire length of the western façade. Because of the complex geometric curvature of each piece of the undulating roof covering the structure, the steel beams were individually hand-welded. The resulting complex sculpture appears to sew the landscape together and flow alongside the cultivated fields that surround it. The steel and glass facade of the building faces west and is equipped with shading devices in textile, partially fixed and partially motorized, which filter natural light into the interior. For Klee's watercolours, canvases and drawings to be properly preserved, they require a luminosity of between 50 and 100 lux, so artificial light is filtered onto them through white screens.



RELATIONSHIP WITH SURROUNDINGS AND LANDSCAPE

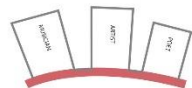
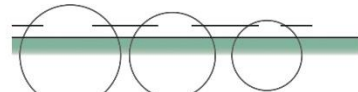

RENZO'S PLAN CONCEPT OF SPLITTING PAUL KLEE'S CAREERS AS A MUSICAL ARTIST AND POET REPRESENTED IN 3 HILLS. MAIN 'STREET' OF CONNECTION FOR CIRCULATION.

INDIVIDUAL INTERPRETATION OF GEOMETRY: IDEA OF 3 SEPERATE CIRCLES WITH HORIZONTAL CIRCULATION.

INTRODUCTION



UNUSED GREEN SPACES

COVERED SEATS: LACK OF ENOUGH COVERED SPORT STADIUM

POLISPORTIVA FIRENZE QUEST: PROVIDE SPORT ACTIVITY FOR YOUNG PEOPLE. THIS PLACE WORKS AS A SOLUTION FOR CONNECTING DIFFERENT PEOPLE WITH DIFFERENT NATIONALITY TOGETHER.

VIPER THEATRE: IT WORKS AS A DISC ONE TIME IN A MONTH. THE RESIDENTS OF THE PIAZZE HAVE SOME PROBLEM WITH DRINKING AND DRUGGED PEOPLE.

PINOCCHIO SQUARE

UNFINISHED RESIDENTIAL BUILDING: SOME IMMIGRANTS LIVE IN THE BUILDING USUALLY IN A VERY BAD SITUATION.

GREEN SPACES: HUGE GREEN SPACES IN THE PIAZZE. HAVE REMAINED UNUSED BECAUSE OF LACK OF ACTIVITY, LIGHTING, LAND SCAPING,...

SOCIO COOP: ORGANIZES MUSIC COURSES FOR CHILDREN WHO LIVING IN LE PIAZZE NEIGHBORHOOD WITH DIFFERENT NATIONALITY.

COMMERCIAL CENTER: THE ONLY SQUARE OF THE PIAZZE THAT CLOSSES EVERY NIGHT AT 9 O'CLOCK.

CULTURAL COMMUNITY OF THE PIAZZE: THE ONLY MEETING PLACE FOR CHILDREN THAT ORGANIZES DIFFERENT EDUCATIONAL ACTIVITIES AND ITALIAN COURSES FOR FOREIGNERS.

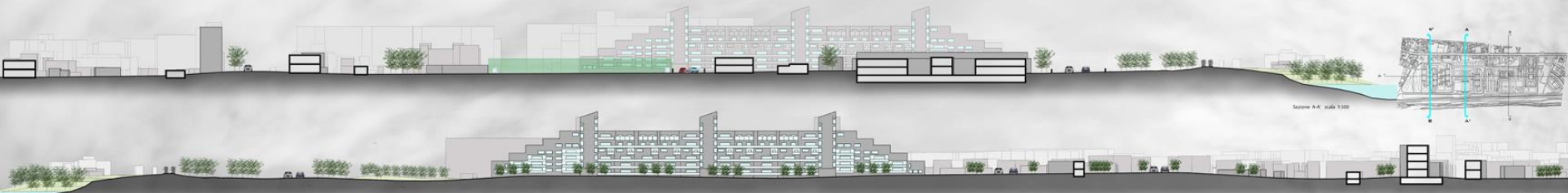

Functions and roles of the existing open spaces

ANALYSIS

SCALE 1:1000

CRITICAL GREEN SPACES IN LE PIAGGE



PARK
IT IS THE HUGE GREEN AREA THAT CAN BE CONSIDERED AS PARK OF LE PIAGGE BUT WITH POOR AND INEFFECTIVE ACTIVITIES AND LANDSCAPING

HILLS
THE HILLS ESPECIALLY THOSE BETWEEN NAVI ARE CRITICAL ELEMENTS BECAUSE THEY JUST CUT THE SPACE

FOOTBALL FIELD
THE FOOTBALL FIELD IS NOT IN A RIGHT POSITION, IT DOESN'T NEED THE HISTORICAL CENTER FROM VIA BRIGADE

VIPER THEATRE GREEN PART
THE INDIVIDUAL GREEN PARTS AROUND THE VIPER THEATRE

THE BACK SQUARE OF RESIDENTIAL
HERE IS THE LITTLE SQUARE WITH GREEN BARRIERS AROUND BUT IT BECOMES ALWAYS EMPTY AND UNSAFE

LONGITUDINAL GREEN AREA
LONGITUDINAL GREEN AREA ALONG THE STREET IS SO EMPTY AND ANONYMOUS

RESIDENTIAL GREEN PART
THE AREA IS DISCONNECTED FROM SURROUNDING BECAUSE OF EXISTING HILL AND ITS KIND OF UNSAFE DURING THE NIGHT

SOCIAL CENTER GREEN
THE HUGE GREEN SPACE WITHOUT ACTIVITIES, BENCHES AND LANDSCAPE IN GENERAL

HORSES AREA
MESSY AND NOT ORGANIZED AREA

LONGITUDINAL GREEN AREA
LONGITUDINAL GREEN AREA ALONG THE STREET IS SO EMPTY AND ANONYMOUS

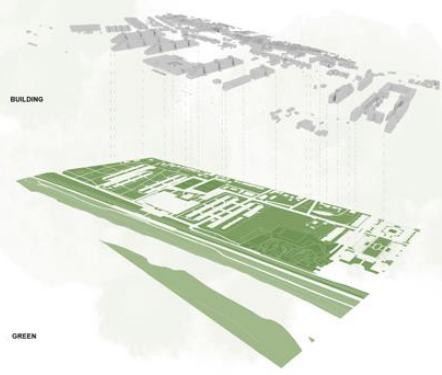

- LEGEND**
- Gardens and public green spaces
 - Private green spaces
 - Private spaces for semi-public use
 - Green spaces along the river
 - Sport field
 - Kids playground
 - Pedestrian spaces newly accommodation
 - Pedestrian spaces of historical value
 - Vehicular spaces of historical interest
 - Vehicular space
 - Parking
 - Cycle road
 - Railway



critical issues and potentialities

CRITICAL GREEN SPACES IN LE PIAGGE

PARK
IT IS THE HUGE GREEN AREA THAT CAN BE CONSIDERED AS PARK OF LE PIAGGE; BUT WITH POOR AND INSIGNIFICANT ACTIVITIES AND LANDSCAPING

HILLS
THE HILLS SPECIALLY THOSE BETWEEN NAVARE ARE CRITICAL ELEMENTS BECAUSE THEY JUST CUT THE SPACE.

FOOTBALL FIELD
THE FOOTBALL FIELD IS NOT IN A RIGHT POSITION. IT DISCONNECTED THE COMMERCIAL CENTER FROM VIA PIETRESE.

VIPER THEATRE GREEN PART
THE ANONYMOUS GREEN PARTS AROUND THE VIPER THEATRE

THE BACK SQUARE OF RESIDENTIAL
HERE IS THE LITTLE SQUARE WITH GREEN GARDENS AROUND BUT IT SEEMS ALWAYS EMPTY AND UNSAFE



LONGITUDINAL GREEN AREA
LONGITUDINAL GREEN AREA ALONG THE STREET IS SO EMPTY AND ANONYMOUS.

RESIDENTIAL GREEN PART
THE AREA IS DISCONNECTED FROM SAURROUNDING BECAUSE OF EXISTING HILL AND IT'S KIND OF UNSAFE DURING TH NIGHT

SOCIAL CENTER GREEN
THE HUGE GREEN SPACE WITHOUT ACTIVITIES, BENCHES AND LANDSCAPE IN GENERAL

HORSES AREA
MESSY AND NOT-ORGANIZED AREA

LONGITUDINAL GREEN AREA
LONGITUDINAL GREEN AREA ALONG THE STREET IS SO EMPTY AND ANONYMOUS.



Hill inside the park area



Small arena inside the park



Park

Structure of existing greenery

STATUS QUO - TREES ANALYSIS

SCALE 1:1000

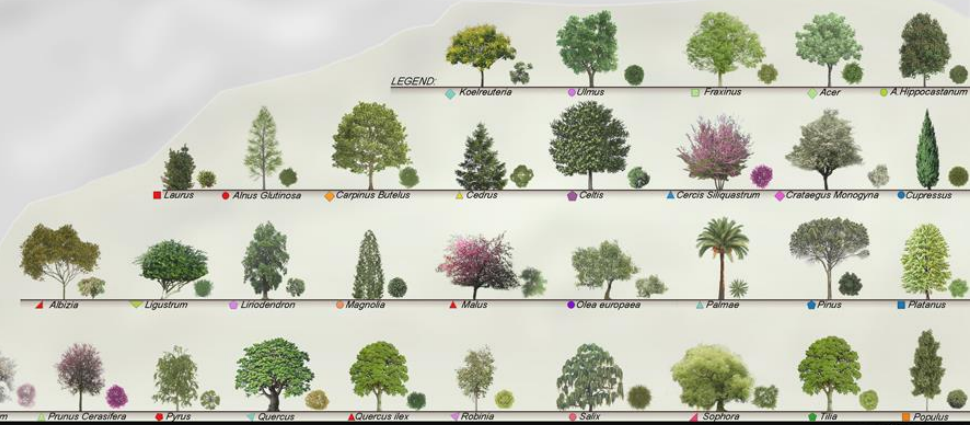

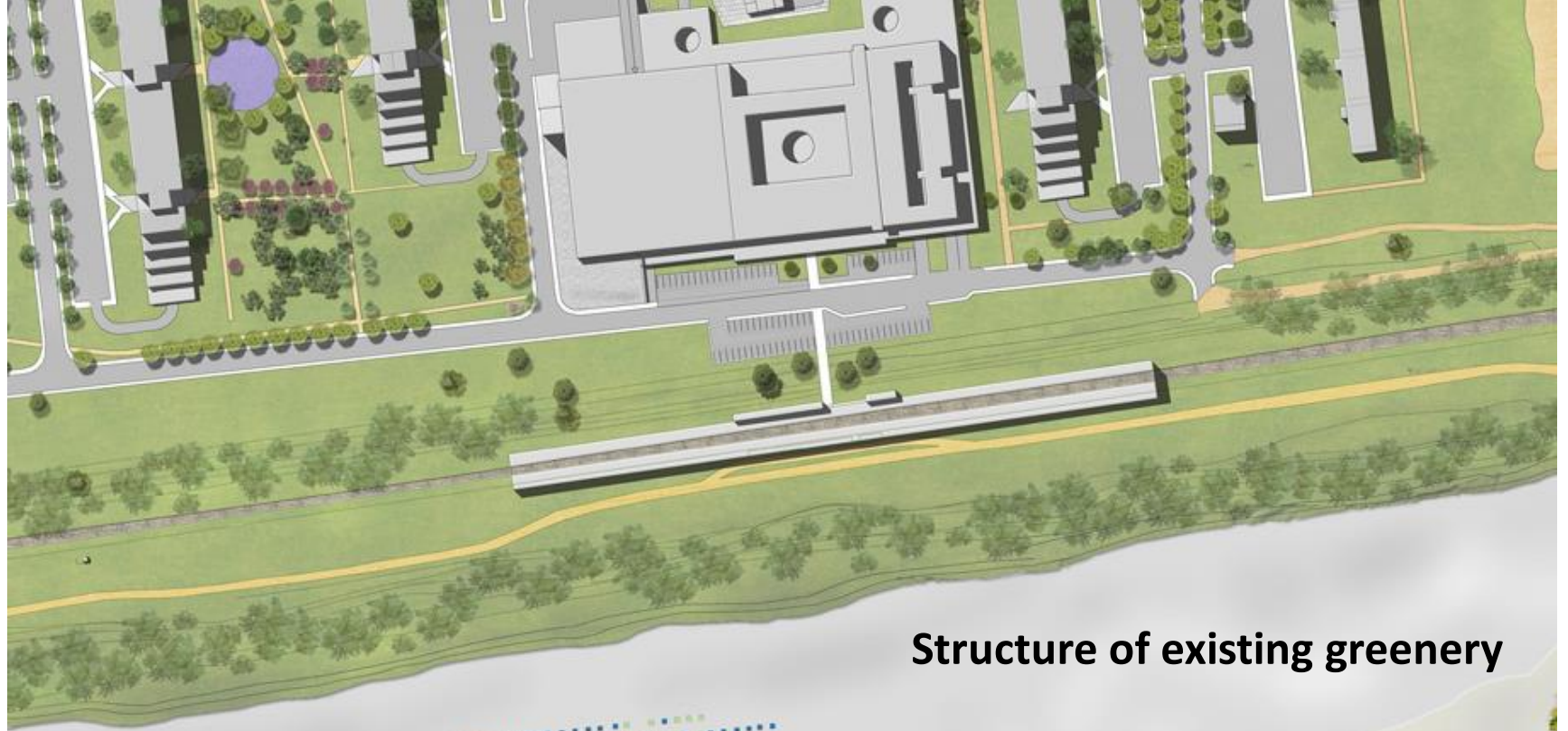

Structure of existing greenery



Strategy

STRATEGIC MAP

SCALE 1:1,000

MISSION
LIVELY NEIGHBORHOOD
ACTIVE PEOPLE

STRATEGY 1	STRATEGY 2	STRATEGY 3
COMFORT AND IMAGE	SOCIABILITY	CONNECTION
<p>GOALS</p> <ul style="list-style-type: none"> SAFE NIGHT LIFE WALKABLE ATTRACTIVE GREEN <p>ACTIONS</p> <ul style="list-style-type: none"> CREATE MORE BUILDINGS, RESIDENCES, SHOPS AND SERVICES CLOSER TOGETHER (CONTINUOUSLY) PROVIDE THE PLACES THAT WORK UNTIL LATE NIGHT LIKE CINEMA, BARS, PUBS AND RESTAURANT RETHINKING ABOUT GREEN AREAS AS A LIVELY PLACES LIKE URBAN FARMING... CREATING ATTRACTIVE ELEMENTS LIKE FOUNTAIN, BENCHES,... IMPROVE LANDSCAPE DESIGN 	<p>GOALS</p> <ul style="list-style-type: none"> INTERACTIVE NEIGHBORLY <p>ACTIONS</p> <ul style="list-style-type: none"> CREATE A CANTER FOR THE PIAGGE INCREASE THE NUMBER OF CULTURAL ACTIVITIES cultural places: library/ amphitheater/ cinema cultural activity: exhibitions/ competition public participation: events/ charity retail sales and local marketing PROVIDE PRIVATE GREEN SPACES BETWEEN NEIGHBORS 	<p>GOALS</p> <ul style="list-style-type: none"> PROXIMITY CONNECTED CONTINUITY <p>ACTIONS</p> <ul style="list-style-type: none"> EXTERNAL CONNECTIVITY CREATE A RELATIONSHIP BETWEEN THE PIAGGE AND OTHER PART OF ARNO. IMPROVE THE CONNECTION BETWEEN THE PIAGGE AND OTHER NEIGHBORHOODS. INTERNAL CONNECTIVITY IMPROVE THE ROADS, PEDESTRAIN AND BIKE PATH INSIDE THE PIAGGE. ENHANCE THE CONNECTION BETWEEN THE PIAGGE AND THE STATION CREATE A CONTINUS URBAN CITY

PROPOSALS

1

PROVIDING URBAN FARMING BETWEEN THE "NAVY" WILL CHANGE THE UNUSED GREEN AREA INTO A VIVID AREA. URBAN VEGETABLE GROWERS SPEND LESS ON TRANSPORT, PACKAGING AND STORAGE, AND CAN SELL DIRECTLY THROUGH STREET FOOD STANDS AND MARKET STALLS. THIS ACTIVITY PROVIDES EMPLOYMENT AND INCOMES FOR POCOR PEOPLE OF NEIGHBORHOOD AND OTHER DISADVANTAGED GROUPS.

2

THE GREEN AREA ALONG THE RAILWAY CAN BE CONSIDERED AS A CONTINUAL SPACE FOR CREATING ACTIVITY SUCH AS RETAIL SALES AND LOCAL MARKETING.

3

RETHINKING ABOUT THE STATION AS RECOGNIZABLE AND COMFORTABLE AND SAFE PLACE.

-MADE A CONNECTION FROM THE STATION TO THE "VIA PIAGGE" AND ALSO FROM THE STATION TO OTHER SIDE OF THE RIVER.

4

LONGITUDINAL GREEN AREA BETWEEN STABLE AND RAILWAY CAN BE DESIGNED FOR PEDESTRAIN, BIKE AND HORSES.

5

CREATING A NEW GREEN SPACE IN FRONT OF THE VIPER IN ORDER TO HAVE A NEW PLEASANT SPACE WITH FLOWER-BOXES, BENCHES AND SMALL KIOSKS FOR INFORMATION, NEWSPAPER, DRINK, ETC.

6

A NEW SPORTIVE CENTER HELDERS SOCCER FIELDS AND OTHER SPORTIVE FACILITIES FOR YOUNG AND OLD. REORGANIZING THE HORSE PARK AND INTEGRATE IT WITH SPORT AREA.

7

CREATING A REAL VIVID SQUARE AS A CENTER OF THE PIAGGE WITH MIX-USAGE ACTIVITIES AROUND IT SUCH AS CULTURAL, ENTERTAINMENT, SHOPPING AND RESIDENTIAL.

THE CULTURAL COMMUNITY OF LE PIAGGE PLACED IN A HUGE GREEN AREA

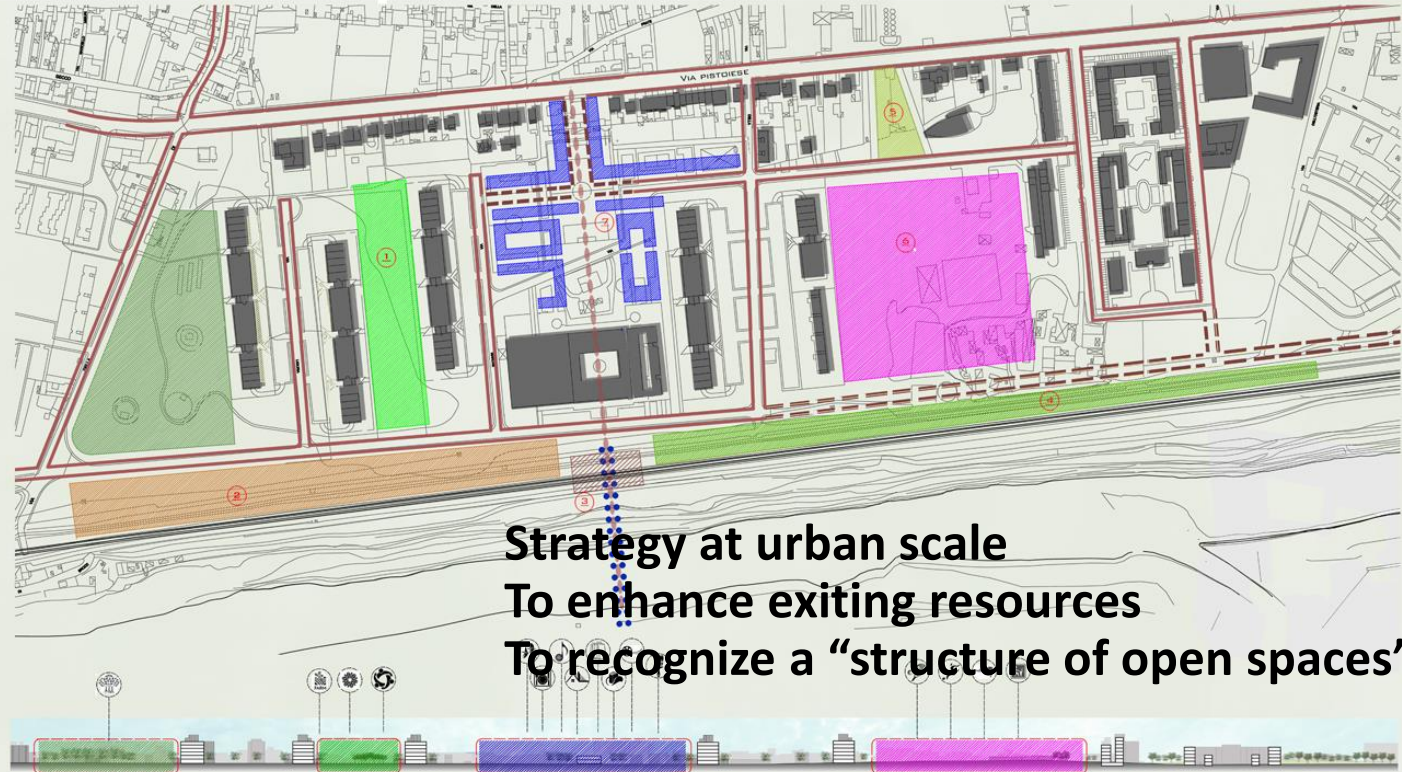

THE GREEN AREA BETWEEN THE TWO OF "NAVY"



Strategy at urban scale
To enhance exiting resources
To recognize a "structure of open spaces"

Master plan

NEW MASTERPLAN

SCALE 1:2000



SECTION A-A SCALE 1:1000

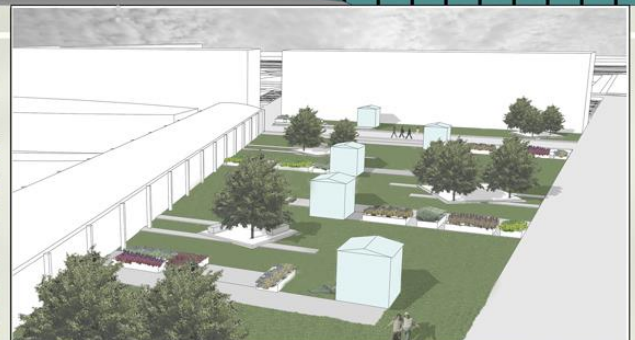

Project: details

PROJECT DETAILS

REFERENCE
 CHAIRS: CENTIUM FOR
 GARTENLUNDT BONDERS DYK
 DESIGNED BY: ROLAND HARTMANN
 ARCHITECTS
 LOCATION: BERLIN, GERMANY
 2012



THAMES BARREN PARK
 DESIGNED BY: SHINE SHINE AND
 PATEL TAYLOR
 LOCATION: LONDON, UNITED
 KINGDOM
 2010



THAMES BARREN PARK
 DESIGNED BY: WITENWALD
 LANDSCAPE ARCHITECTS
 LOCATION: DRESDEN, GERMANY
 2010



DEIDMANN SQUARE PARK
 DESIGNED BY: DUNHAM ARCHITECTS
 LOCATION: IN REIN-CHURCH, UNIVERSITY
 CITY OF BERLIN, GERMANY



URBAN FARMING

SECTION A A
 SC:1:2000



SC:1:10000



SC:1:10000



SC:1:10000



BASKETBALL FIELD
 Recreate a place where young people of any age can meet and enjoy their free time

MASS OF TREE
 The existing tree has remained as they were and the path is going around them.

ARENA AREA

Frederick Meier Gardens, Sculpture Park, Stuttgart

FOUNTAIN

The fountain can make a space more enjoyable specially during the summer for children.

THE SHELTER

Shelter and seats around it can be as an entrance of park designed with flowerboxes that made by recycle paints. A big shelter can use for social events and inviting people for gathering and social interac.



SECTION C-C

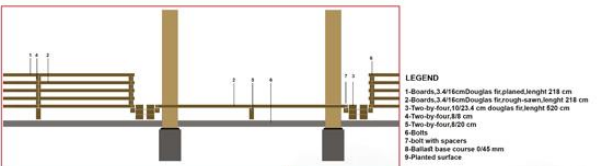

DETAIL A SC:1:10

- LEGEND**
- 1-Board, 3.411cm Douglas fir, length 218 cm
 - 2-Board, 3.411cm Douglas fir, through-wood, length 218 cm
 - 3-Two-by-four, 102.3.4 cm Douglas fir, length 820 cm
 - 4-Two-by-four, 88 cm
 - 5-Two-by-four, 820 cm
 - 6-Grill
 - 7-Post with spacers
 - 8-Ballast base course 645 mm
 - 9-Planted surface

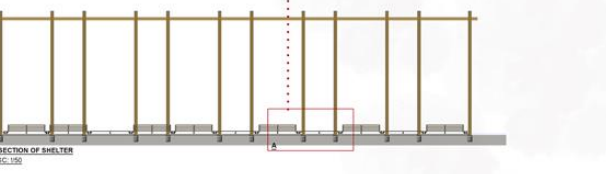

SECTION OF SHELTER SC:1:50

SECTION B B
 SC:1:2000



NEW CIVIC CENTRE

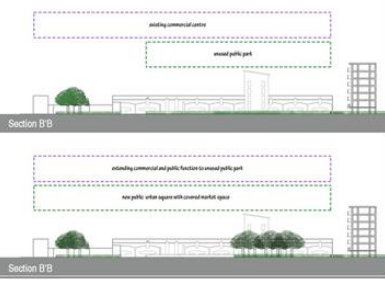
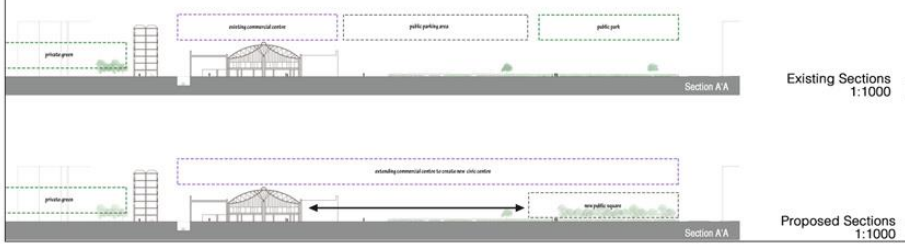
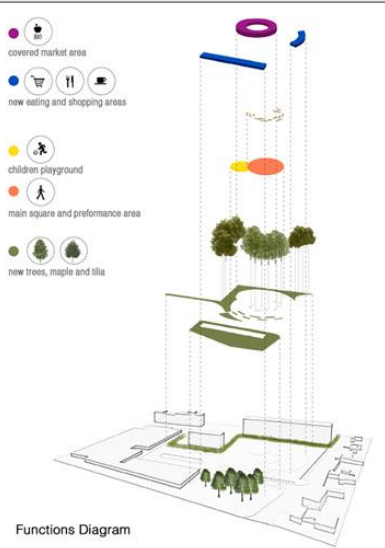

Soil Allowance and Root system for Paved Areas

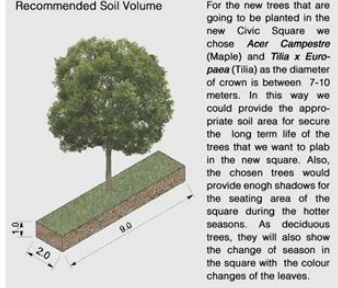

chosen trees and root system

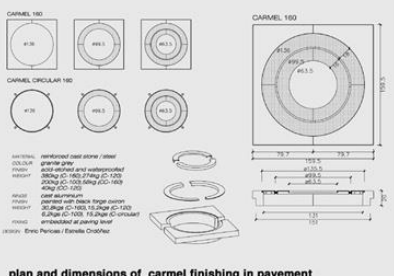

Perspective Section



Project: details

NEW RIBBON PARK

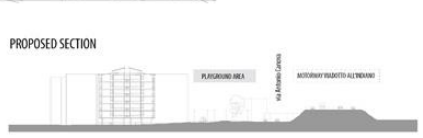
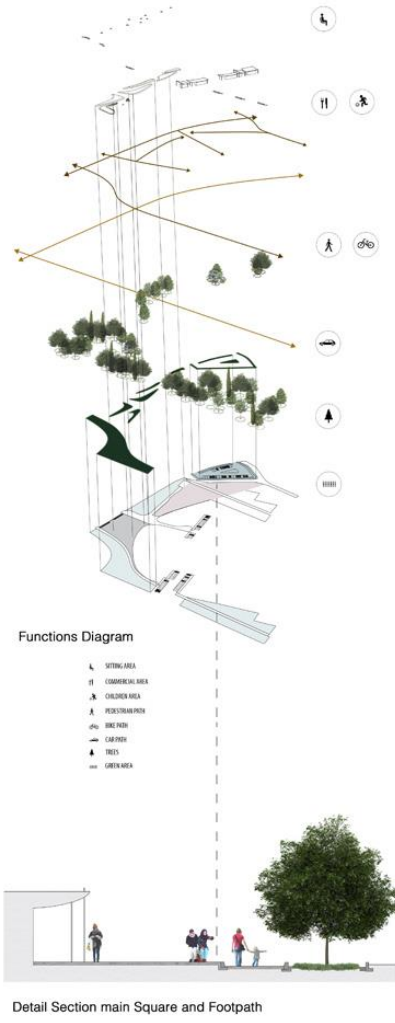
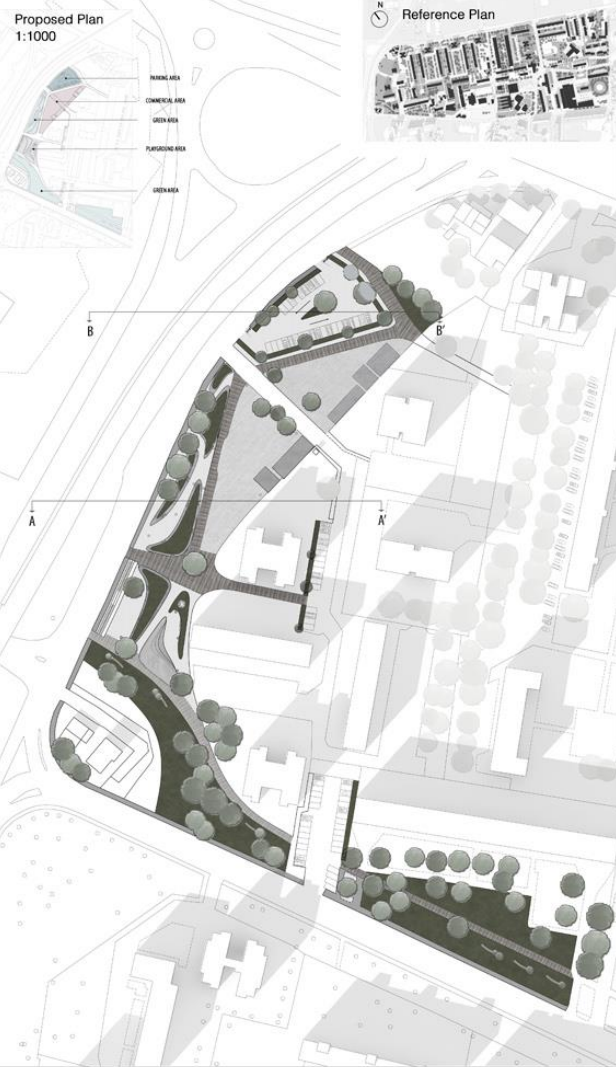

GREEN AREA ANALYSIS

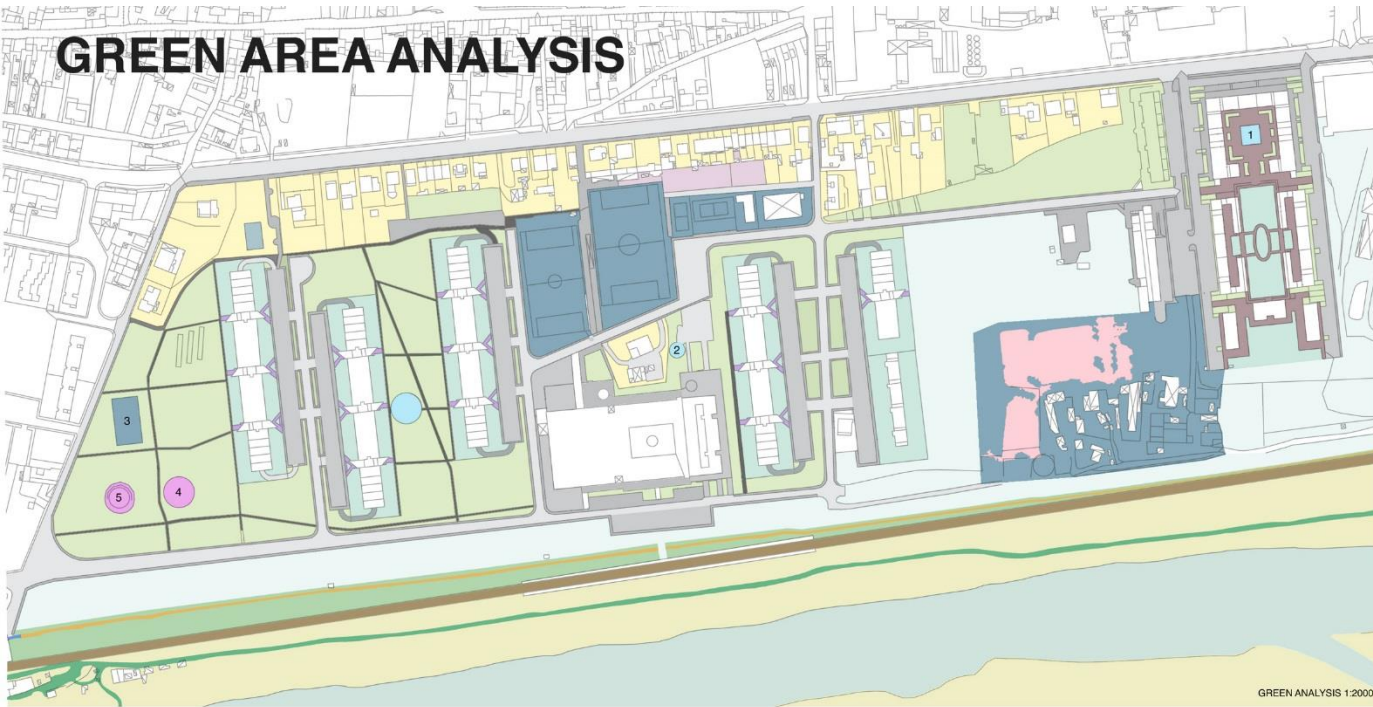

GREEN ANALYSIS 1:2000

GREEN AREA

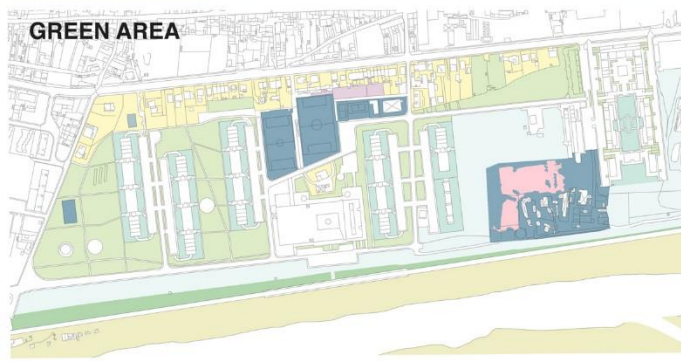

CONNECTIONS

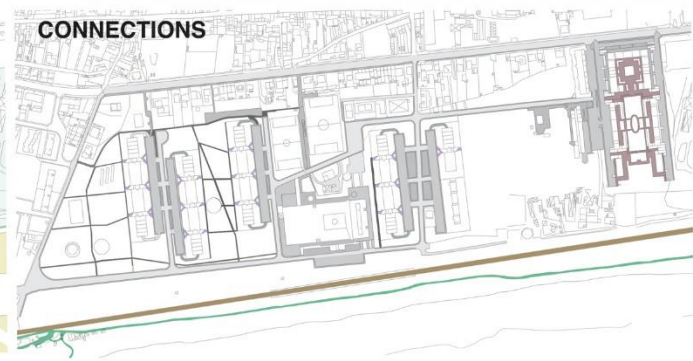

GREEN SPACES

Green spaces exist in a great variety of shapes, structures and types within the city or urban fabric. The successful protection, creation, and development of the spaces is one of the key elements required to achieve sustainable urban development. The study and development of green spaces is, though, a complex subject, due to:

- the incidence of long-term natural processes that are involved in the growth and maturation of the living elements; and
- the fact that they represent public values and have an important role to play for the well-being and health of the inhabitants.

Their public acceptance and appreciation depends on the characteristics they possess, like appropriate provision, quality and accessibility.

The purposes of green space strategy are, therefore:

- to safeguard the future of green spaces;
- to improve the quality of urban areas and especially the neighbourhoods;
- to make urban areas more attractive and thereby attract more resources;
- to enhance the well-being of local people and tourists.

GREEN AREAS

- LOW GRASS AREA
- URBAN ORTHOS
- TALL TREE AREA
- VILLAS PRIVATE GARDEN
- DISTRICT GARDEN
- SPORTS CENTER
- CONDOMINIUM GARDEN
- RIVERBED

ACTIVITIES

- CULTURAL ACTIVITIES
- KIDS PLAYGROUND

CONNECTIONS

- APARTMENT PATHS
- RIVER SIDE PEDESTRIAN PATH
- SIDE WALK
- INTERIOR SIDEWALK
- HORSES SAND PATHS
- INTERIOR CONDOMINIUM PATHS
- STREET
- RAILWAY
- WATER
- WATER CHANNEL
- RIVER

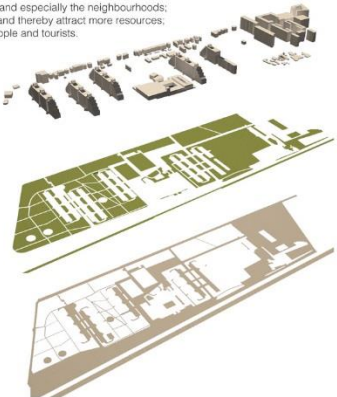



GREEN ANALYSIS 1:2000

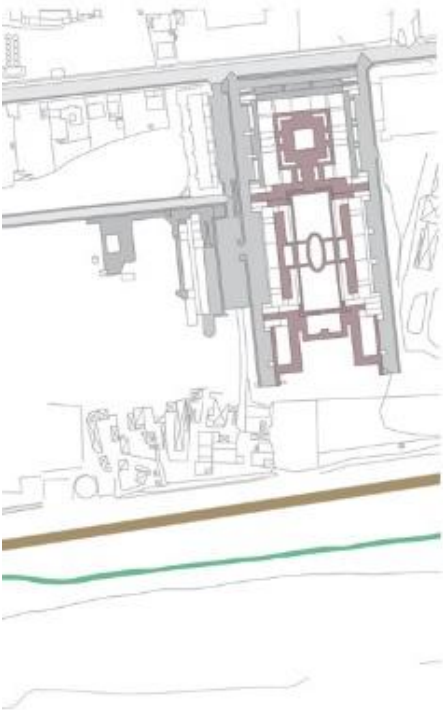

GREEN SPACES

Green spaces exist in a great variety of shapes, structures and types within the city or urban fabric. The successful protection, creation, and development of the spaces is one of the key elements required to achieve sustainable urban development. The study and development of green spaces is, though, a complex subject, due to:

- the incidence of long-term natural processes that are involved in the growth and maturation of the living elements; and
- the fact that they represent public values and have an important role to play for the well-being and health of the inhabitants.

Their public acceptance and appreciation depends on the characteristics they possess, like appropriate provision, quality and accessibility.

The purposes of green space strategy are, therefore:

- to safeguard the future of green spaces;
- to improve the quality of urban areas and especially the neighbourhoods;
- to make urban areas more attractive and thereby attract more resources;
- to enhance the well-being of local people and tourists.

GREEN AREAS

- LOW GRASS AREA
- URBAN ORTHOS
- TALL TREE AREA
- VILLAS PRIVATE GARDEN
- DISTRICIT GARDEN
- SPORTS CENTER
- CONDOMINIUM GARDEN
- RIVERBED

ACTIVITIES

- CULTURAL ACTIVITIES
- KIDS PLAYGROUND

CONNECTIONS

- APARTMENT PATHS
- RIVER SIDE PEDESTRIAN PATH
- SIDE WALK
- INTERIOR SIDEWALK
- HORSES SAND PATHS
- INTERIOR CONDOMINIUM PATHS
- STREET
- RAILWAY

WATER

- WATER CHANNEL
- RIVER

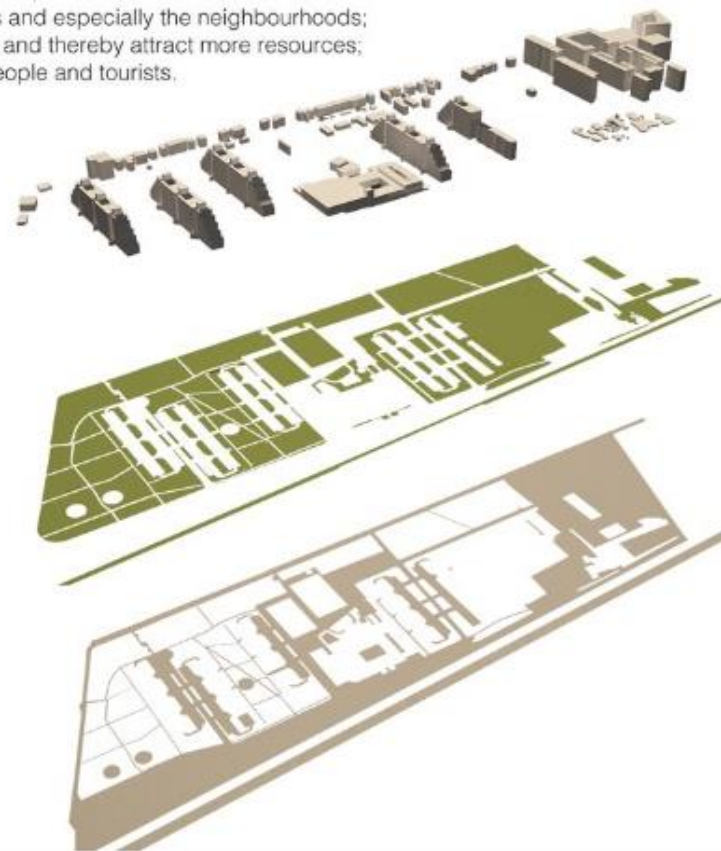

Strategy

STRATEGY

CONCEPT

LE PIAGGE

family



Le Piagge Family is a concept that is closely related to our visits and interviews with the residents, in which we recognized the traits of a family in the community of Le Piagge. This concept is the base of the community since they already feel like a big family and this appeared within the conversations as a common opinion between all.

Le Piagge Family as a concept wants to provide activities for all the generations in the same space. All the family is going to have the opportunity to develop different kinds of activities.

In the community, seen as a big family, the members share their diversities while each contributing with different qualities and are bound by love and caring for their neighborhood.

EVERYBODY'S SPACE



- 1 Provide wide sidewalks with a variety of streetscape elements to enhance the pedestrian experience and to encourage extensive pedestrian traffic.
- 2 Create an easily accessible destination by foot, bike, public transit and vehicle. Acknowledge and enhance the train stop dual role as a destination and as a gateway to Florence.
- 3 Create a community for everyone, including families, working professionals, seniors and students by creating a vibrant public reality with a variety of activities, public spaces and opportunities for interaction.
- 4 Encourage and promote quality architecture and urban design in the area.
- 5 Enhance the connection to the River through improved wayfinding and an extended, marked pedestrian and bicycle pathway.
- 6 Create a public gathering space that is highly connected to the park, the shopping mall, the street and to the surrounding neighbourhood.
- 7 Maintain on-street parking opportunities to provide a buffer between pedestrians and vehicular traffic.



ANALYSIS ASPECTS

FIGURE/GROUND

The strategy that we adopted is based on our analysis that we made. First thing we studied the area from a morphologic point of view considering the figure/ground plan that shows the different density of built spaces between Le Piagge and the old settlements in Brozzi and also how the dimension of public spaces and green areas changes from one place to another.

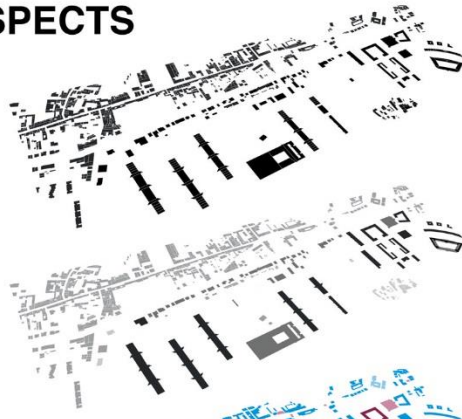

BUILDING HEIGHTS

Considerable is also the contrast among the height of the buildings in Le Piagge and the ones beyond Via Pistoiese. Studying this aspect made us realize that in Le Piagge either there are very tall buildings or massive green areas. That's why we are going to fill this gap designing human size buildings and pavilions that are going to make the inhabitants feel more comfortable in their area.



FUNCTION PLAN

We also investigated about the diverse intended use of the buildings in the area from residential to commercial, from community spaces to sport facilities and about the circulation of the area, considering vehicular, bicycle and pedestrian paths. Brozzi and Quaracchi are where the main concentration of commercial areas are located leaving Le Piagge as a mainly residential district.



PEDESTRIAN PATHS

We consider this network and analyzed the most used pedestrian paths in it observing how people walk in Le Piagge, and we found out a hierarchy of places that will help us designing new spaces for the inhabitants.

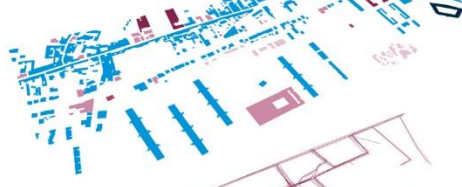

CRITICAL GREEN AREAS

Our observation also brought us to recognize and understand some important points in the zone, especially to respect to the green areas that we classified as the most used by the residents. The area located to the western side of Le Piagge given to the characteristics is the mainly used by the citizens.



CIRCULATION

The analysis about connections shows how Le Piagge is divided from Brozzi and Quaracchi by Via Pistoiese that creates a physical and cultural boundary between the inhabitants. It is clear that Le Piagge has only one main connection with Via Pistoiese, Via della Sala, limiting the permeability of the district. The circulation develops only in Via Lazio and Via Lombardia, in a horizontal axis, and Via Lombardia, in a vertical axis, as the main vehicular arterials of the district.



VISION

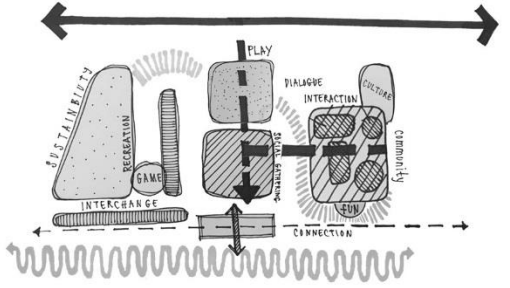

URBAN DESIGN VISION PLAN

The Vision Plan shows an example of the applications of the analysis. It includes a Park, a Community Center, the neighborhood development, and a Urban Farming Park connected by livable streets, greenways and pedestrian and bicycle paths.



- Park**
This area is envisioned as an environmental area with enhancement and recreation opportunities. The park is going to be a point of encounter for different generations where they will interact within a mesh of activities.
- Community Center**
The Community Center is intended as a mix of community uses, including Library, Art School, Workshops, Auditorium, After-school, Computer-room, Meeting space, Cinema, Administrative Offices and Cafeteria.
- Urban Farming Park**
The main goal of the urban farming is to provide a space where the community will gather while learning about the importance of the healthy food and collaborating between each other to benefit the neighborhood.

LONG-TERM OUTCOMES

This vision should become the focus for achieving long-term outcomes for the neighborhood: confidence, stronger sense of community, growth, employment, promotion and connectivity. A well-designed public environment, including parks, streets, squares, transit, bicycle amenity and architecture will help to ensure the ongoing success of the area. The Vision will fully contribute to a positive renewal.

CHALLENGES / OPPORTUNITIES

<p>Pedestrian Environment</p> <p>C</p> <ul style="list-style-type: none"> Isolated, deserted sidewalks discourage walking and contribute to a negative image of the area. Intersections are often unfriendly to pedestrians and can make crossing difficult. Vast areas of greenery makes pedestrians feel exposed. 	<p>O</p> <ul style="list-style-type: none"> A new streetscape improvement to address the pedestrian through designed and more integrated sidewalks. Re zoning will encourage walkable, mixed-use development along Le Navi.
<p>Transportation</p> <p>C</p> <ul style="list-style-type: none"> Conflict currently exists between different modes of transportation. Quoted and is not pedestrian-friendly. 	<p>O</p> <ul style="list-style-type: none"> opportunity to extend bicycle facilities and network through an extension of the shared use pathway system. opportunity to improve a permeability through connections
<p>Public Spaces</p> <p>C</p> <ul style="list-style-type: none"> Public spaces lack programming and positive activities. 	<p>O</p> <ul style="list-style-type: none"> opportunity to expand and improve public spaces A square that incorporates a new Community Center Residents are passionate about their community and desire to access to high-quality, well-designed and well programmed public spaces.

Master plan

MASTER PLAN

THE EVOLUTION OF THE CURVE

Le Piaggio Family is a project that wants to give the community a sense of belonging not only of living the place but also of transforming it through time and space. That is why our proposal always starts in the Social Analysis because we understood that the community of Le Piaggio already has a strong social identity. Through the interviews we made they expressed that they felt already as a family, and the project is thought to emphasize this feeling of family by creating activities in the same space for different age range.

The project was developed by proposing a strong contrasting design of the existing project of Le Piaggio built in the late 80's and the new proposal; the contrast was created using mainly a curved line to design the new elements of the masterplan. This curved line was inspired by the analysis of the paths that the people took and the most important of this paths broke the straight lines of the original proposal of Le Piaggio. This Social alterations were the ones that inspired the project to go on a more organic form breaking completely from the visual aesthetic of the original design.

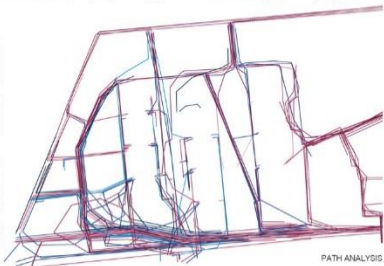

PATH ANALYSIS

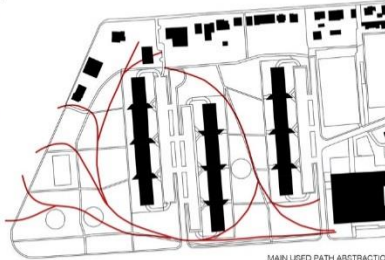

MAIN USED PATH ABSTRACTION

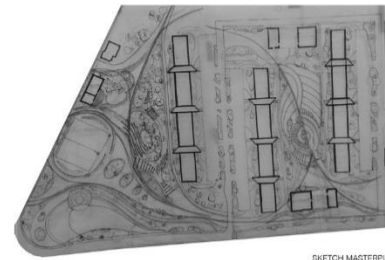

SKETCH MASTERPLAN

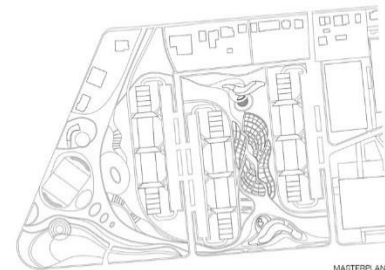

MASTERPLAN



MASTERPLAN 1:2000



AERIAL PARK VIEWS



PARK PERGOLAS



HILL VIEW TO MAIN PARK ROAD



SKATE PARK

Project: details

THE SPACE IN BETWEEN

The space, in between Le Navi, interested us from the beginning of our analysis. Since we first arrived in Le Piaggio, we suddenly notice this extensive area closed by two massive grey buildings that made this field seem even longer, as far as the eye can see. During our observations this space appeared like an unused zone with a lot of big brownish grass areas, a not so lived playground and, by contrary, paths that are often used as shortcut through the west side of Le Piaggio.

In order to that we thought about ways to make this in between space a more liveable space and not just a crossing point. Therefore, our landscape design in this area breaks the rigid form of the bulky buildings creating a human scale space that can be used by everyone, from kids to older people, to better know the territory they live in.



The shapes in our project creates a liveable flow in this area, both giving structure and generating views for a scenic function.

The design of a pleasant path, which extends along the new urban gardening area, and of the two organic-shaped buildings, will develop this area in a more valuable semi-public zone, avoiding degradation.

Considering the tall building around this area we designed a trans-scale project that can be seen also from balconies or rooftops. In this way the interweaving of the design can be appreciated from different views and heights, and people will have a more involved relation with the landscape.

We used the structure of the trees to organize perspective views and provide shadow. The trees are the same as the ones that we found in the area for type and, where possible, location.



CULTURAL CENTER

In our project the space in between Le Navi is "closed" on the short sides by two buildings that share the same language with the landscape design.

These buildings are designed for the whole community and with two different "functions". While one building is a Public Sport Center the other is a Cultural Center, giving this area the opportunity to hold different kind of initiatives, inside and outside the buildings.

This Cultural center is going to serve the Le Piaggio families of services now missing in the area and it will extend the open hour of the activities in the district, creating movement and purpose to an area otherwise deserted.

The center hosts a library, a cinema, an outdoor auditorium, an art school and a little restaurant providing amenities for all kind of users.

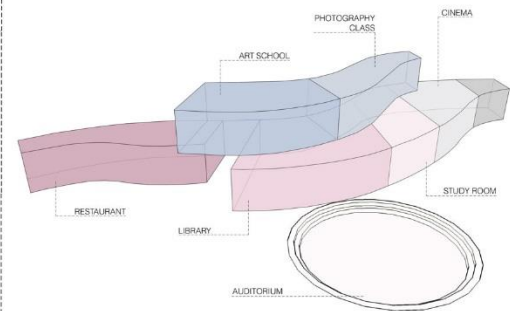

URBAN FARMING

We designed the Urban Farming area to give to the residents of Le Piaggio a way to enjoy the fruits of the green spaces that surround them, often underappreciated.

These spaces are designed as private zones in a semi-public area, so that everyone can appreciate the view while passing by or while sitting on a bench relaxing.



FOOD EDUCATION PROGRAM

The urban farming area is dedicated both for adult residents and kids from the schools in the district. We reserved one zone to the children of any grade, so that they can have their own little garden to learn skills about food, to appreciate nature's products and how they affect their body.

The Food Education Program, taught both in the farming and in schools, will contribute to the wellness, healthy growth, and development of their culture.



REFERENCES



The Park at Lakeshore East
Designed by: The Office of James Burnett
Location: Chicago, Illinois, USA
2009



Value Farm
Designed by: Thomas Chung
Location: Shenzhen, China
2014



Hyakudoren, The Awaaji Yumezaki Memorial
Designed by: Tadao Ando
Location: Awaaji Island, Japan
1999



Ramirez Residential Tower
Designed by: Terra
Location: Tel Aviv, Israel
2006

Master plan

International College of Architectural Design (ICAD) - s.a.2017/8 - ARCHITECTURE AND
 Thesis Lab
 Prof. Ghemmen Ghali, Arshvia Vahedi, Souda Amini
 Teaching assistants: Ushv Goshra, Maha Dara Madi
 STUDENT: Amir Farhat, Amir Mehdi Davoudi

COMMUNITY GARDENS
 To accommodate multiple spaces for agriculture, the design team is introducing a small-scale agriculture for urban centers. This will allow people to utilize their own growing space and enjoy the benefits of fresh produce. The design team is also introducing a small-scale agriculture for urban centers. This will allow people to utilize their own growing space and enjoy the benefits of fresh produce. The design team is also introducing a small-scale agriculture for urban centers. This will allow people to utilize their own growing space and enjoy the benefits of fresh produce.



LANDSCAPE ELEMENTS TO BE ADDED

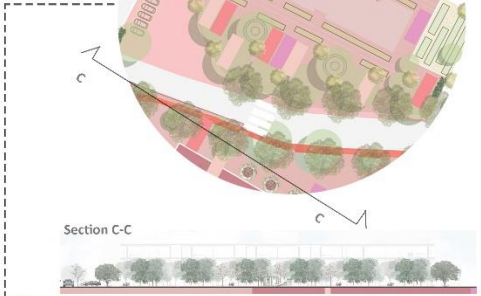
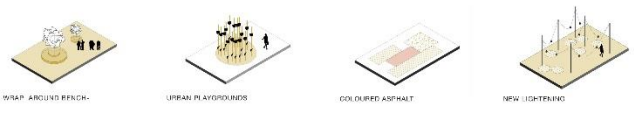

MASTER PLAN
SCALE 1:2000

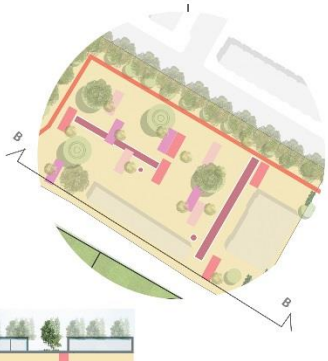

Green spine property line - - - - -



1. BIRDAI COMMUNITY GARDEN, BIRDAI, BIRDAI, BIRDAI, BIRDAI, BIRDAI
 2. THE PARKING PLACE, THE PARKING PLACE, THE PARKING PLACE
 3. THE PARKING PLACE, THE PARKING PLACE, THE PARKING PLACE
 4. THE PARKING PLACE, THE PARKING PLACE, THE PARKING PLACE
 5. THE PARKING PLACE, THE PARKING PLACE, THE PARKING PLACE
 6. THE PARKING PLACE, THE PARKING PLACE, THE PARKING PLACE

REFERENCES

Master plan

PROPOSALS



LEISURE TIME

1. Park & Amphitheatre

The goal of creating this park was to connect lolo to Tobbiana. Also it has an open space amphitheatre arranged for events and other activities. The inhabitants can use this huge park and have leisure time there.

Greenery of this park and trees can help to reduce the noise of factories and also air pollution.



AGRICULTURE

2. Community Garden

Community garden can be viewed as particular locations of collective activities that serve a range of ends. For instance, community gardening may be part of a broader discourse to create more sustainable and ethical forms of living while also offering alternative ways of 'being' and community enhancement in the city. This active sense of place is important to the development of our interrogation of work practices in community gardens. Places are the meeting ground where diverse and sometimes conflicting economic identities come together and interact.



MARKET PLACE

3. Market and open space

In this area we removed the field next to the street and proposed a square with some facilities like cafe and markets to bring people together on a boarder of Vergaio and Tobbiana. The goal was to improve the green spine direction and have some interction of people. People now can stay there while they can use cafe and markets to amuse them.



OPEN SQUARE

4. Open square and Park

The goal of this area was to improve pedestrian path, so the street was removed in order to have a huge square for people and bicycle. Asphalt painting also improves the identity of this huge area and also the green spine.



SOCIAL HOUSING

5. Social Housing

We proposed a social housing and car park and pavilion as a multiple function among green spine and next to the new square which improves the identity and make some public and semi public spaces for people.

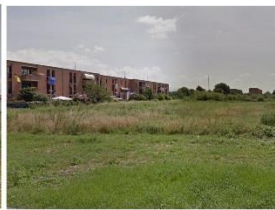

SOCIAL HOUSING

6. Social Housing

The purpose of this new Social housing was came out from Vivazz social housing and we used wooden panels as a facade to adjust the temperature of the inner part because they are moveable. So inhabitants can have privacy by closing these panies or have a nice view of the square.

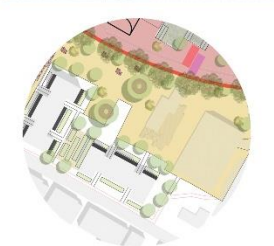

Stratigraphy Analysis

LAND USE

The land use maps involves the residence, industrial and social area. we can observe how the industrial area located contiguous residential building. According to the pie chart we can recognize the industrial area are the most part of our zone.

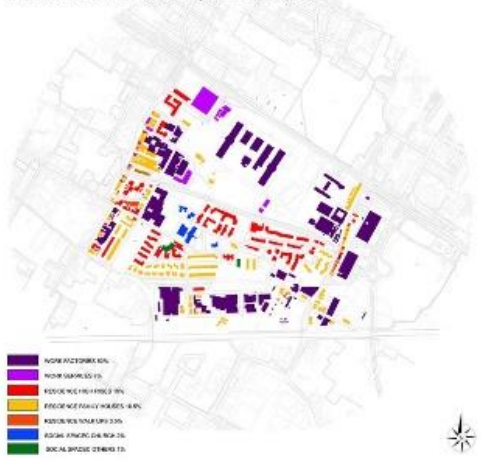

GREEN AREA

Most of the unused green area is in and around ex fabrica Banci and a huge land as a barrier between residential and industrial area. A green stretch like a buffer zone is between main road and industrial land organised green spaces are near high rise apartment buildings.

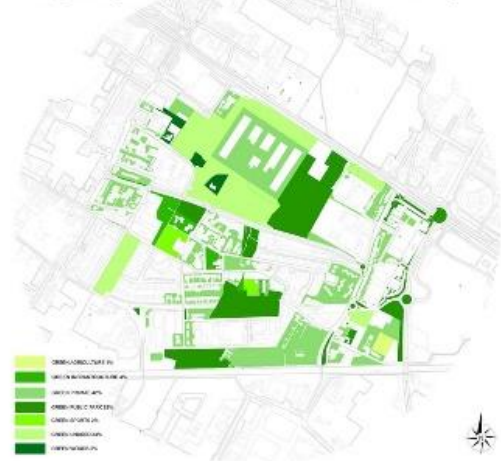

WORK SPACE

Our work areas are included the Questura ,institute of medicine , shops ,factories, auto repairs , auto shops , restaurants ,supermarkets ,bars , ...

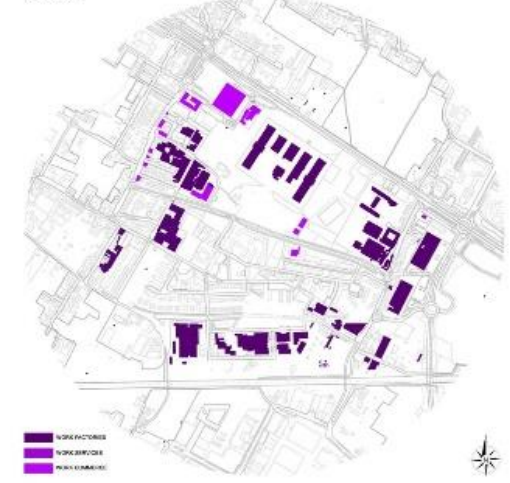

ASPHALT BUILDINGS

From the illustration we would like to explain relation between private asphalts and parking areas with main roads. Main asphalts and parking spaces are covered by industries and automobile warehouses. There are very less private asphalts in the community.while the high rise apartments have sufficient asphalt parking areas.



PUBLIC TRANSPORT

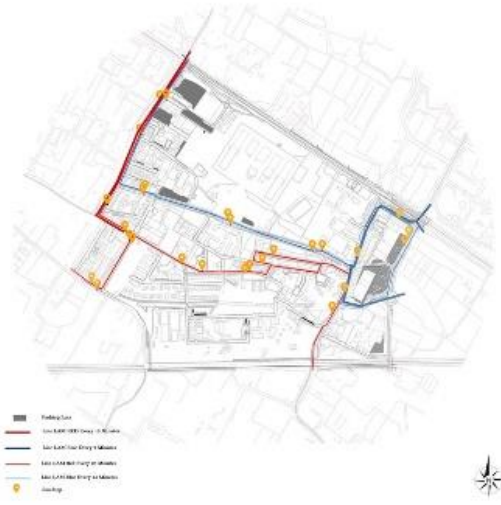

PUBLIC SPACE

The public spaces that are existence in our part include elementary school 'LE FONTI', kinder garden 'LE BADIE', church 'PARROCCHIA S. PIO X' national "deaf people-section" in prato

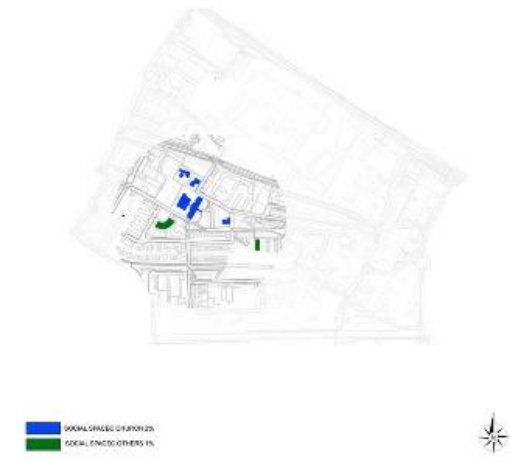

Master plan

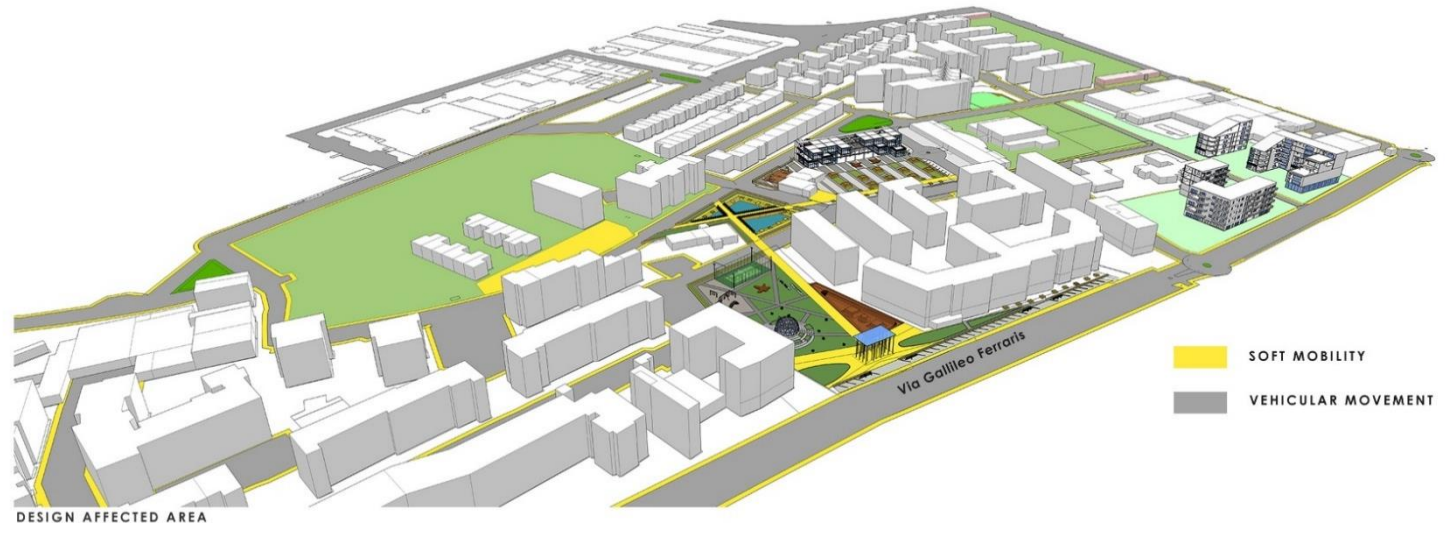

Project: details

LE BADIAMO

CIVIC CENTRE-PIAZZA-MEDITATION CENTRE-PLAY AREA-LEISURE PARK

Resiprocating the number of people using public spaces happens when there are efficient play areas and interesting building architecture.

Le badie to be a best community for a happy livelihood and good social life various parts of existing community have been revitalized.



- | | | | | | |
|--------------|-------------------|--------------------|----------------|--------------|-----------------------------|
| CIVIC CENTRE | MEDITATION CENTRE | ENTRANCE PAVILLION | SKATING RINK | TENNIS COURT | PRIMAY SCHOOL, KINDERGARTEN |
| PIAZZA | WATER POND/OAT | BASKET BALL COURT | KIDS PLAY AREA | CHURCH | RESIDENTIAL BUILDINGS |



SUGGESTED BIBLIOGRAPHY

theory

Council of Europe, *European Landscape Convention*, Florence 20.10.2000

Gilles Clément, "*The Planetary Garden" and Other Writings*, Translated by Sandra Morris.
Foreword by Gilles A. Tiberghien, University of Pennsylvania Press 2016

Elizabeth Kugler (Author), *Intermediate Nature: the landscape of Michel Desvigne*, Birkhäuser
Architecture, 1 edition 2008

SUGGESTED BIBLIOGRAPHY

History

Philip de Bay, James Balton, *Gardenmania*, Thames & Hudson, London 2000

Maureen Carroll, *Earthly paradises: Ancient gardens in history and archaeology*, Los Angeles: J. Paul Getty Museum 2003

Geoffrey and Susan Jellicoe, *The landscape of man: shaping the environment from prehistory to the present day* Thames and Hudson, 1975

Monique Mosser, Georges Teyssot (Editors), *The History of Garden Design: The Western Tradition from the Renaissance to the Present Day*, Thames & Hudson 2000

Norman T Newton, *Design on the land: the development of landscape architecture* Belknap/Harvard 1971

Chip Sullivan, Elizabeth Boult, *Illustrated History of Landscape Design*, John Wiley & Sons Hoboken New Jersey 2010

Marc Treib, *Modern landscape architecture: a critical review*, MIT press Cambridge (Mass)-London 1993

Mariella Zoppi, *The European Garden*, Angelo Pontecorboli, Firenze 2016

SUGGESTED BIBLIOGRAPHY

Projects references

Philip Jodido, *Landscape Architecture Now*, Taschen Cologne 2012

LAE, Landscape Architecture Europe, *Fieldworks*, Birkhauser, Basel 2006

International Biennial of Landscape Architecture, various catalogue, ed. Paysage:
“*Remaking Landscapes*” (1999), “*Gardens in Arms*” (2001), “*Only with Nature*” (2003),
“*Landscape: a Product / a Production*” (2006), “*Storm & stress*” (2008), “*Liquid Landscape*”
(2010), “*Biennial versus Biennial*” (2012), “*A Landscape for You*” (2014)
[Next “*Tomorrow Landscapes*” 2016 to be published]

PAYS.MED.URBAN, *Good Practices for Landscape. Catalogue of good practices for the landscape in periurban areas*, 2011

SUGGESTED BIBLIOGRAPHY

Themes

Patric Blanc, *The Vertical Garden, from nature to the cities*, Norton Press 2009

Anna Lambertini, *Vertical Gardens*, Thames & Hudson, London 2007

Whitney North Seymour, *Small Urban Spaces: The Philosophy, Design, Sociology, and Politics of Vest-Pocket Parks and Other Small Urban Open Spaces*, New York University Press, 1969

David Tracey, *Guerrilla Gardening: A Manual* New Society Publishers. 2007